

TorqTaper Plus® Bushing Kits Unit Sizes 107-115

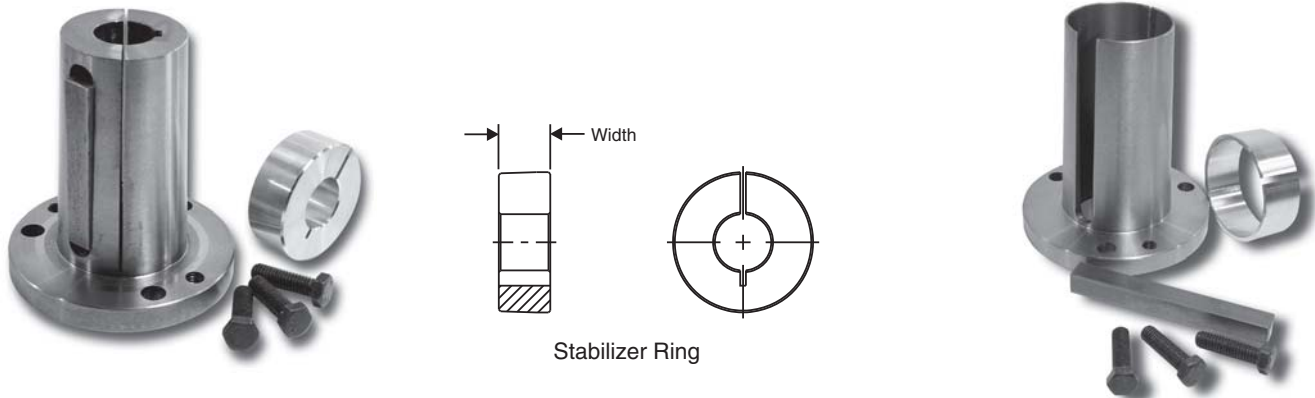

Stabilizer Ring

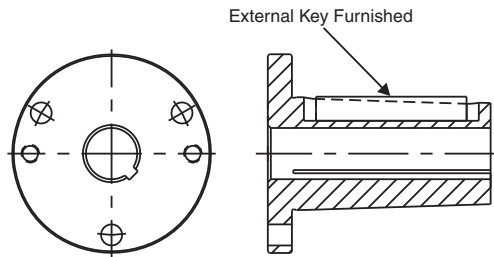

Type 1

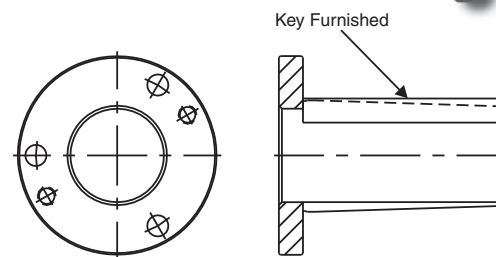

Type 2

| REDUCER SIZE | BUSHING NO. | BORE SIZE | SHAFT KEYSEAT REQUIRED | TYPE | STABILIZER RING WIDTH | BOLT TORQUE | | WEIGHT |
|--------------|-------------|-----------|------------------------|------|-----------------------|-----------------|---------|--------|
| | | | | | | BOLT SIZE | FT.LBS. | |
| 107SM TP | 107TBP012 | 3/4 | 3/16 x 3/32 x 3 7/8 | 1 | 0.793 | 5/16-18 x 1 1/4 | 16 | 2.6 |
| | 107TBP014 | 7/8 | 3/16 x 3/32 x 3 7/8 | 1 | | | | 2.5 |
| | 107TBP015 | 15/16 | 1/4 x 1/8 x 3 7/8 | 2 | | | | 2.4 |
| | 107TBP100 | 1 | 1/4 x 1/8 x 3 7/8 | 2 | | | | 2.3 |
| | 107TBP101 | 1 1/16 | 1/4 x 1/8 x 3 7/8 | 2 | | | | 2.1 |
| | 107TBP102 | 1 1/8 | 1/4 x 1/8 x 3 7/8 | 2 | | | | 2.0 |
| | 107TBP103 | 1 3/16 | 1/4 x 1/8 x 3 7/8 | 2 | | | | 1.9 |
| | 107TBP104 | 1 1/4 | 1/4 x 1/8 x 3 7/8 | 2 | | | | 1.8 |
| | 107TBP105 | 1 5/16 | 5/16 x 5/32 x 3 7/8 | 2 | | | | 1.6 |
| | 107TBP106 | 1 3/8 | 5/16 x 5/32 x 3 7/8 | 2 | | | | 1.5 |
| | 107TBP107 | 1 7/16 | 3/8 x 3/16 x 3 7/8 | 2 | | | | 1.5 |
| 115SM TP | 115TBP015 | 15/16 | 1/4 x 1/8 x 4 1/8 | 1 | 0.855 | 3/8-16 x 1 1/4 | 29 | 6.0 |
| | 115TBP100 | 1 | 1/4 x 1/8 x 4 1/8 | 1 | | | | 5.9 |
| | 115TBP101 | 1 1/16 | 1/4 x 1/8 x 4 1/8 | 1 | | | | 5.7 |
| | 115TBP102 | 1 1/8 | 1/4 x 1/8 x 4 1/8 | 1 | | | | 5.6 |
| | 115TBP103 | 1 3/16 | 1/4 x 1/8 x 4 1/8 | 1 | | | | 5.4 |
| | 115TBP104 | 1 1/4 | 1/4 x 1/8 x 4 1/8 | 1 | | | | 5.3 |
| | 115TBP105 | 1 5/16 | 5/16 x 5/32 x 4 1/8 | 2 | | | | 5.1 |
| | 115TBP106 | 1 3/8 | 5/16 x 5/32 x 4 1/8 | 2 | | | | 4.8 |
| | 115TBP107 | 1 7/16 | 3/8 x 3/16 x 4 1/8 | 2 | | | | 4.7 |
| | 115TBP108 | 1 1/2 | 3/8 x 3/16 x 4 1/8 | 2 | | | | 4.4 |
| | 115TBP110 | 1 5/8 | 3/8 x 3/16 x 4 1/8 | 2 | | | | 4.0 |
| | 115TBP111 | 1 11/16 | 3/8 x 3/16 x 4 1/8 | 2 | | | | 3.7 |
| | 115TBP112 | 1 3/4 | 3/8 x 3/16 x 4 1/8 | 2 | | | | 3.5 |
| | 115TBP115 | 1 15/16 | 1/2 x 1/4 x 4 1/8 | 2 | | | | 2.7 |

Note: When using shafts smaller than the largest bushing bore shown for a specific reducer, shaft stress based on the transmitted load must always be checked to ensure shaft can handle torque produced.



TorqTaper Plus® Bushing Kits Unit Sizes 203-215

| REDUCER SIZE | BUSHING NO. | BORE SIZE | SHAFT KEYSEAT REQUIRED | TYPE | STABILIZER RING WIDTH | BOLT TORQUE | | WEIGHT |
|--------------|-------------|-----------|------------------------|------|-----------------------|----------------|--------|--------|
| | | | | | | BOLT SIZE | FTLBS. | |
| 203SMTP | 203TBP103 | 1 3/16 | 1/4 x 1/8 x 4 5/8 | 1 | 0.980 | 3/8-16 x 1 1/4 | 29 | 7.5 |
| | 203TBP104 | 1 1/4 | 1/4 x 1/8 x 4 5/8 | 1 | | | | 7.3 |
| | 203TBP105 | 1 5/16 | 5/16 x 5/32 x 4 5/8 | 1 | | | | 7.1 |
| | 203TBP106 | 1 3/8 | 5/16 x 5/32 x 4 5/8 | 1 | | | | 6.9 |
| | 203TBP107 | 1 7/16 | 3/8 x 3/16 x 4 5/8 | 1 | | | | 6.6 |
| | 203TBP108 | 1 1/2 | 3/8 x 3/16 x 4 5/8 | 2 | | | | 6.1 |
| | 203TBP110 | 1 5/8 | 3/8 x 3/16 x 4 5/8 | 2 | | | | 5.9 |
| | 203TBP111 | 1 11/16 | 3/8 x 3/16 x 4 5/8 | 2 | | | | 5.6 |
| | 203TBP112 | 1 3/4 | 3/8 x 3/16 x 4 5/8 | 2 | | | | 5.4 |
| | 203TBP114 | 1 7/8 | 1/2 x 1/4 x 4 5/8 | 2 | | | | 4.8 |
| | 203TBP115 | 1 15/16 | 1/2 x 1/4 x 4 5/8 | 2 | | | | 4.4 |
| | 203TBP200 | 2 | 1/2 x 1/4 x 4 5/8 | 2 | | | | 4.2 |
| | 203TBP203 | 2 3/16 | 1/2 x 1/4 x 4 5/8 | 2 | | | | 3.1 |

| | | | | | | | | |
|---------|-----------|---------|---------------------|---|-------|----------------|----|-----|
| 207SMTP | 207TBP106 | 1 3/8 | 5/16 x 5/32 x 5 1/8 | 1 | 1.040 | 3/8-16 x 1 1/4 | 29 | 9.6 |
| | 207TBP107 | 1 7/16 | 3/8 x 3/16 x 5 1/8 | 1 | | | | 9.3 |
| | 207TBP108 | 1 1/2 | 3/8 x 3/16 x 5 1/8 | 1 | | | | 9.1 |
| | 207TBP110 | 1 5/8 | 3/8 x 3/16 x 5 1/8 | 2 | | | | 8.5 |
| | 207TBP111 | 1 11/16 | 3/8 x 3/16 x 5 1/8 | 2 | | | | 8.3 |
| | 207TBP112 | 1 3/4 | 3/8 x 3/16 x 5 1/8 | 2 | | | | 7.9 |
| | 207TBP114 | 1 7/8 | 1/2 x 1/4 x 5 1/8 | 2 | | | | 7.3 |
| | 207TBP115 | 1 15/16 | 1/2 x 1/4 x 5 1/8 | 2 | | | | 6.9 |
| | 207TBP200 | 2 | 1/2 x 1/4 x 5 1/8 | 2 | | | | 6.6 |
| | 207TBP202 | 2 1/8 | 1/2 x 1/4 x 5 1/8 | 2 | | | | 5.9 |
| | 207TBP203 | 2 3/16 | 1/2 x 1/4 x 5 1/8 | 2 | | | | 5.5 |
| | 207TBP204 | 2 1/4 | 1/2 x 1/4 x 5 1/8 | 2 | | | | 5.1 |
| | 207TBP207 | 2 7/16 | 5/8 x 5/16 x 5 1/8 | 2 | | | | 3.9 |

| | | | | | | | | |
|---------|-----------|---------|--------------------|---|-------|----------------|----|------|
| 215SMTP | 215TBP107 | 1 7/16 | 3/8 x 3/16 x 5 5/8 | 1 | 1.140 | 3/8-16 x 1 3/8 | 29 | 14.9 |
| | 215TBP108 | 1 1/2 | 3/8 x 3/16 x 5 5/8 | 1 | | | | 14.5 |
| | 215TBP111 | 1 11/16 | 3/8 x 3/16 x 5 5/8 | 1 | | | | 13.6 |
| | 215TBP112 | 1 3/4 | 3/8 x 3/16 x 5 5/8 | 1 | | | | 13.2 |
| | 215TBP114 | 1 7/8 | 1/2 x 1/4 x 5 5/8 | 2 | | | | 12.6 |
| | 215TBP115 | 1 15/16 | 1/2 x 1/4 x 5 5/8 | 2 | | | | 12.2 |
| | 215TBP200 | 2 | 1/2 x 1/4 x 5 5/8 | 2 | | | | 11.9 |
| | 215TBP203 | 2 3/16 | 1/2 x 1/4 x 5 5/8 | 2 | | | | 10.7 |
| | 215TBP204 | 2 1/4 | 1/2 x 1/4 x 5 5/8 | 2 | | | | 9.80 |
| | 215TBP207 | 2 7/16 | 5/8 x 5/16 x 5 5/8 | 2 | | | | 8.90 |
| | 215TBP208 | 2 1/2 | 5/8 x 5/16 x 5 5/8 | 2 | | | | 8.50 |
| | 215TBP211 | 2 11/16 | 5/8 x 5/16 x 5 5/8 | 2 | | | | 7.00 |
| | 215TBP215 | 2 15/16 | 3/4 x 3/8 x 5 5/8 | 2 | | | | 5.00 |

Note: When using shafts smaller than the largest bushing bore shown for a specific reducer, shaft stress based on the transmitted load must always be checked to ensure shaft can handle torque produced.

TorqTaper Plus® Bushing Kits Unit Sizes 307-315

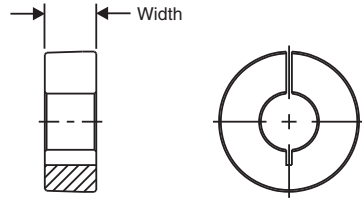

Stabilizer Ring

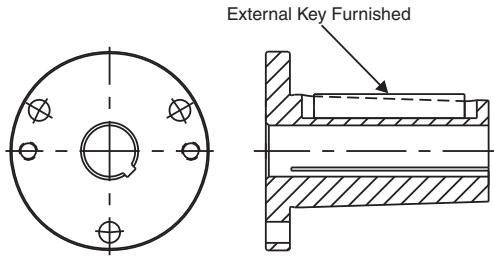

External Key Furnished

Type 1

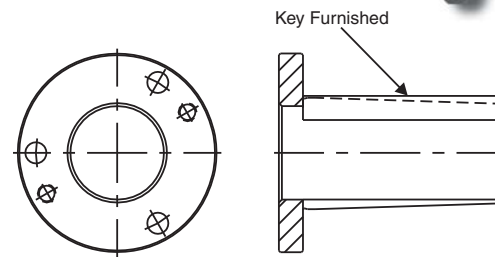

Key Furnished

Type 2

| REDUCER SIZE | BUSHING NO. | BORE SIZE | SHAFT KEYSEAT REQUIRED | TYPE | STABILIZER RING WIDTH | BOLT TORQUE | | WEIGHT |
|--------------|-------------|-----------|------------------------|------|-----------------------|----------------|---------|--------|
| | | | | | | BOLT SIZE | FT.LBS. | |
| 307SMTP | 307TBP115 | 1 15/16 | 1/2 x 1/4 x 6 3/4 | 1 | 1.45 | 1/2-13 x 1 5/8 | 65 | 21.61 |
| | 307TBP200 | 2 | 1/2 x 1/4 x 6 3/4 | 1 | | | | 21.13 |
| | 307TBP203 | 2 3/16 | 1/2 x 1/4 x 6 3/4 | 1 | | | | 19.76 |
| | 307TBP204 | 2 1/4 | 1/2 x 1/4 x 6 3/4 | 1 | | | | 19.27 |
| | 307TBP206 | 2 3/8 | 5/8 x 5/16 x 6 3/4 | 2 | | | | 18.28 |
| | 307TBP207 | 2 7/16 | 5/8 x 5/16 x 6 3/4 | 2 | | | | 17.68 |
| | 307TBP208 | 2 1/2 | 5/8 x 5/16 x 6 3/4 | 2 | | | | 17.08 |
| | 307TBP211 | 2 11/16 | 5/8 x 5/16 x 6 3/4 | 2 | | | | 15.36 |
| | 307TBP214 | 2 7/8 | 3/4 x 3/8 x 6 3/4 | 2 | | | | 13.51 |
| | 307TBP215 | 2 15/16 | 3/4 x 3/8 x 6 3/4 | 2 | | | | 12.89 |
| | 307TBP300 | 3 | 3/4 x 3/8 x 6 3/4 | 2 | | | | 12.76 |
| | 307TBP306 | 3 3/8 | 7/8 x 7/16 x 6 3/4 | 2 | | | | 7.55 |
| | 307TBP307 | 3 7/16 | 7/8 x 7/16 x 6 3/4 | 2 | | | | 7.11 |

| REDUCER SIZE | BUSHING NO. | BORE SIZE | SHAFT KEYSEAT REQUIRED | TYPE | STABILIZER RING WIDTH | BOLT TORQUE | | WEIGHT |
|--------------|-------------|-----------|------------------------|------|-----------------------|----------------|---------|--------|
| | | | | | | BOLT SIZE | FT.LBS. | |
| 315SMTP | 315TBP207 | 2 7/16 | 5/8 x 5/16 x 7 15/16 | 1 | 1.69 | 1/2-13 x 1 3/4 | 65 | 30.89 |
| | 315TBP208 | 2 1/2 | 5/8 x 5/16 x 7 15/16 | 1 | | | | 30.47 |
| | 315TBP211 | 2 11/16 | 5/8 x 5/16 x 7 15/16 | 1 | | | | 28.09 |
| | 315TBP213 | 2 13/16 | 3/4 x 3/8 x 7 15/16 | 1 | | | | 26.83 |
| | 315TBP214 | 2 7/8 | 3/4 x 3/8 x 7 15/16 | 1 | | | | 26.09 |
| | 315TBP215 | 2 15/16 | 3/4 x 3/8 x 7 15/16 | 2 | | | | 23.95 |
| | 315TBP300 | 3 | 3/4 x 3/8 x 7 15/16 | 2 | | | | 22.90 |
| | 315TBP303 | 3 3/16 | 3/4 x 3/8 x 7 15/16 | 2 | | | | 20.65 |
| | 315TBP307 | 3 7/16 | 7/8 x 7/16 x 7 15/16 | 2 | | | | 17.10 |
| | 315TBP315 | 3 15/16 | 1 x 1/2 x 7 15/16 | 2 | | | | 11.24 |

Note: When using shafts smaller than the largest bushing bore shown for a specific reducer, shaft stress based on the transmitted load must always be checked to ensure shaft can handle torque produced.

TorqTaper Plus® Bushing Kits Unit Sizes 407-800

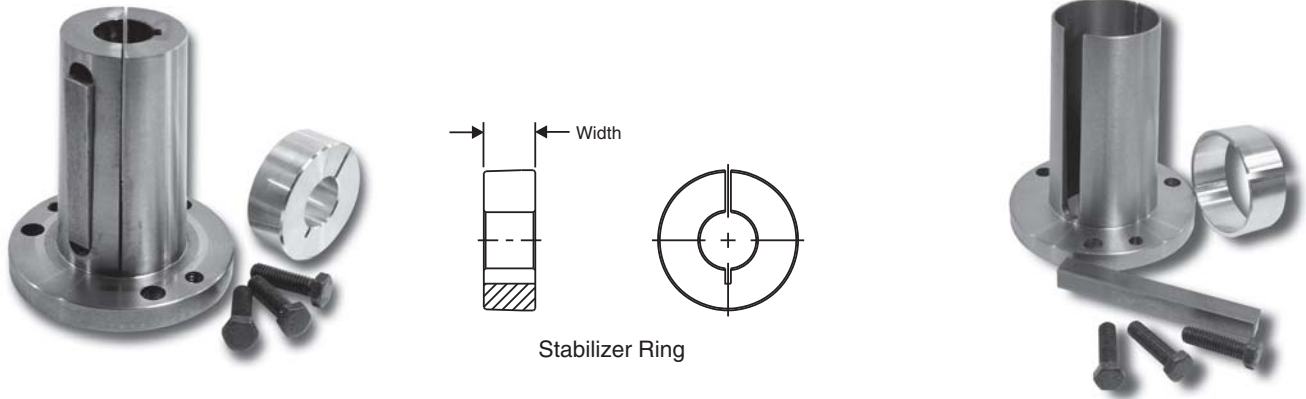

Stabilizer Ring

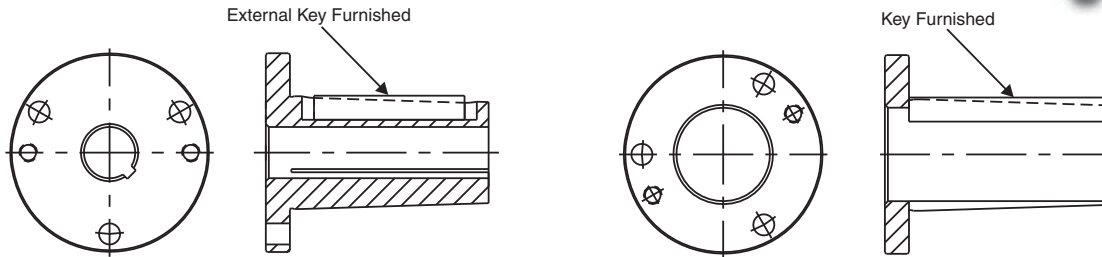

Type 1

Type 2

| Reducer Size | Bushing No. | Bore Size | Shaft Keyseat Required | Type | Stabilizer Ring Width | Bolt Torque | | Weight |
|--------------|-------------|------------|------------------------|------------------|-----------------------|----------------|---------------|--------|
| | | | | | | Bolt Size | Ft. Lbs. | |
| 407SMTP_B | 407TBP215B | 2 15/16 | 3/4 x 3/8 x 7 1/2 | 1 | 1.56 | 1/2-13 x 1 3/4 | 65 | 30.2 |
| | 407TBP303B | 3 3/16 | 3/4 x 3/8 x 7 1/2 | 2 | | | | 29.3 |
| | 407TBP307B | 3 7/16 | 7/8 x 7/16 x 7 1/2 | 2 | | | | 26.5 |
| | 407TBP315B | 3 15/16 | 1 x 1/2 x 7 1/2 | 2 | | | | 20.1 |
| | 407TBP403B | 4 3/16 | 1 x 1/2 x 7 1/2 | 2 | | | | 16.5 |
| | 407TBP407B | 4 7/16 | 1 x 1/2 x 7 1/2 | 2 | | | | 12.6 |
| 415SMTP_B | 415TBP307B | 3 7/16 | 7/8 x 7/16 x 9 1/4 | 2 | 1.59 | 5/8-11 x 2 | 140 | 53.1 |
| | 415TBP315B | 3 15/16 | 1 x 1/2 x 9 1/4 | 2 | | | | 44.4 |
| | 415TBP403B | 4 3/16 | 1 x 1/2 x 9 1/4 | 2 | | | | 40.1 |
| | 415TBP407B | 4 7/16 | 1 x 1/2 x 9 1/4 | 2 | | | | 35.5 |
| | 415TBP408B | 4 1/2 | 1 x 1/2 x 9 1/4 | 2 | | | | 34.2 |
| | 415TBP415B | 4 15/16 | 1 1/4 x 5/8 x 9 1/4 | 2 | | | | 25.6 |
| 507SMTP_B | 507TBP315B | 3 15/16 | 1 x 1/2 x 10 3/8 | 2 | 1.56 | 3/4-10 x 2 1/4 | 250 | 65.0 |
| | 507TBP403B | 4 3/16 | 1 x 1/2 x 10 3/8 | 2 | | | | 59.0 |
| | 507TBP407B | 4 7/16 | 1 x 1/2 x 10 3/8 | 2 | | | | 54.0 |
| | 507TBP415B | 4 15/16 | 1 1/4 x 5/8 x 10 3/8 | 2 | | | | 45.0 |
| | 507TBP507B | 5 7/16 | 1 1/4 x 5/8 x 10 3/8 | 2 | | | | 37.0 |
| | 608SMTP_B | 608TBP507B | 5 7/16 | 1 1/4 x 5/8 x 11 | | | | 2 |
| 608TBP515B | | 5 15/16 | 1 1/2 x 3/4 x 11 | 2 | 72.0 | | | |
| 608TBP600B | | 6 | 1 1/2 x 3/4 x 11 | 2 | 70.0 | | | |
| 608TBP607B | | 6 7/16 | 1 1/2 x 3/4 x 11 | 2 | 64.0 | | | |
| 608TBP608B | | 6 1/2 | 1 1/2 x 3/4 x 11 | 2 | 63.0 | | | |
| 800SMTP | | 800TBP515 | 5 15/16 | 1 1/2 x 3/4 x 11 | 2 | 1.88 | 7/8-9 x 2 3/4 | 400 |
| | 800TBP600 | 6 | 1 1/2 x 3/4 x 11 | 2 | 165.0 | | | |
| | 800TBP608 | 6 1/2 | 1 1/2 x 3/4 x 11 | 2 | 147.0 | | | |
| | 800TBP700 | 7 | 1 3/4 x 7/8 x 11 | 2 | 128.0 | | | |
| | 800TBP800 | 8 | 2 x 1 x 11 | 2 | 84.0 | | | |

Note: When using shafts smaller than the largest bushing bore shown for a specific reducer, shaft stress based on the transmitted load must always be checked to ensure shaft can handle torque produced.